

LIQUID MEMBRANE™ DETAIL

SEMCO Liquid Membrane™ over wood

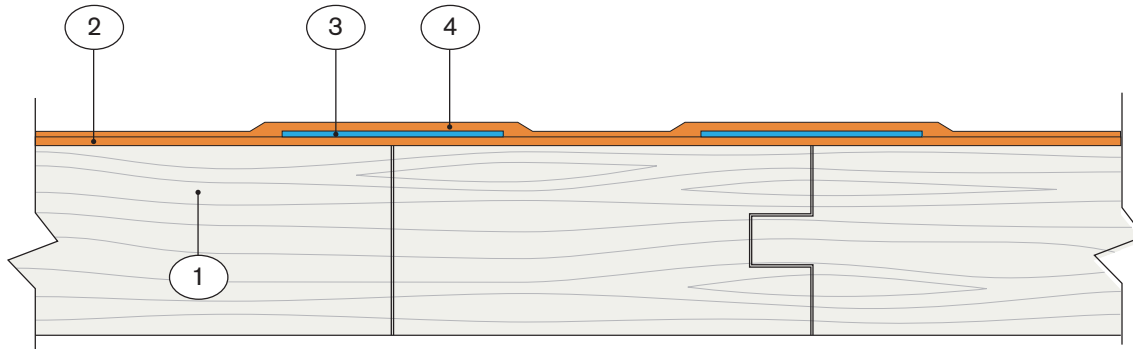

- 1. Existing substrate - wood
- 2. SEMCO Liquid Membrane™ - Roll 1 (generous) coat of Liquid Membrane
- 3. Fabric reinforcement - While still wet, apply anti-fracture cloth to sheet joints, fabric sheets should overlap by 50mm
- 4. SEMCO Liquid Membrane™ - Roll a 2nd (generous) coat of Liquid membrane ensuring the anti-fracture cloth is completely covered

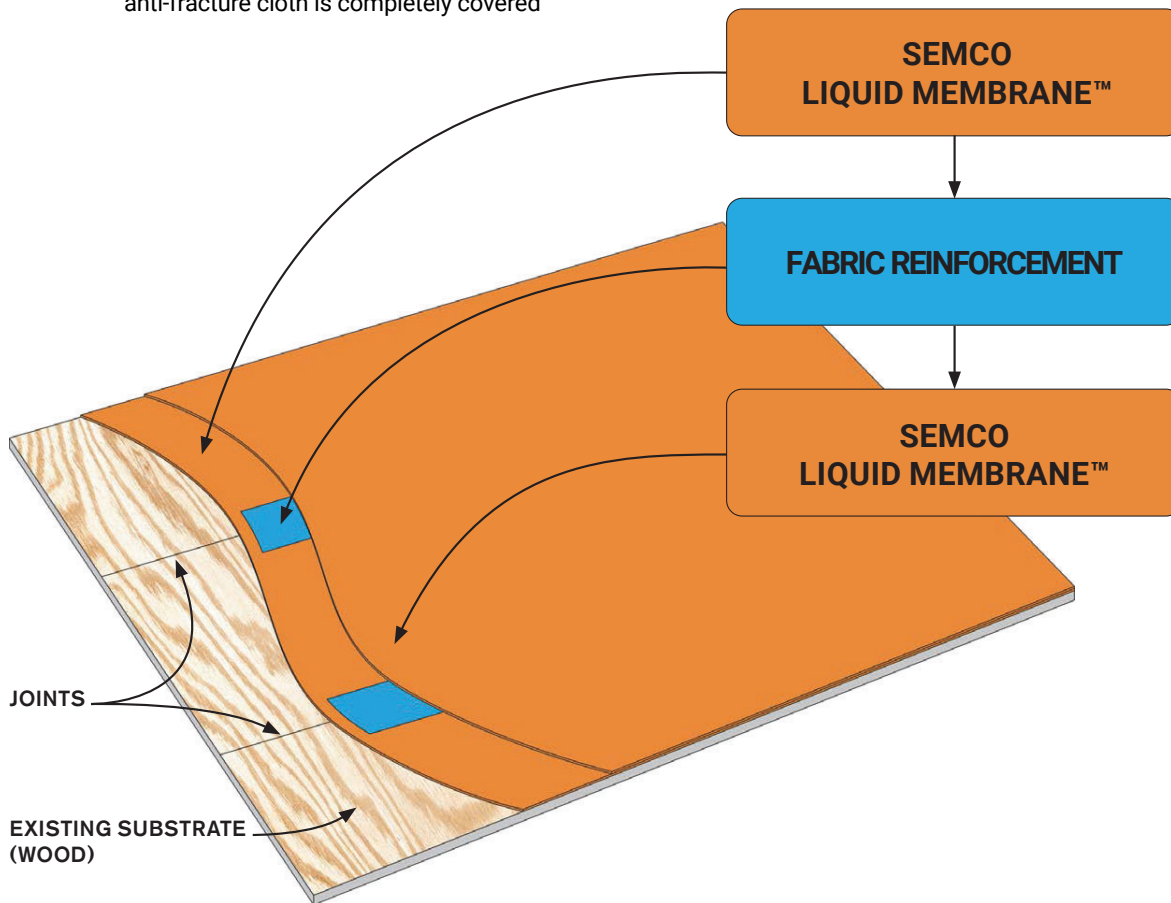

FLOORS | WALLS | POOL DECKS | WATERPROOFING
REDEFINING THE ART OF SURFACE CREATIVITY FOR OVER 25 YEARS USING GREEN MATERIALS



Seamless Overlays Pty Ltd

Exclusive suppliers of X-Bond & Quartz Carpet™

329 Darebin Road, Thornbury VIC 3071 | +613 9977 5876 | sales@seamlessoverlays.com | seamlessoverlays.com